



Features

- PF-9017 measure up .
- Switching capacity up to 80A.
- Direct insert mounting available.
- Suitable for automotive multi-control.

ORDERING INFORMATION

	PR120-80A/	012	1 A
Type			
Coil voltage:	6,12, 24VDC		
Contact arrangement:	1A:1 Form A		

CONTACT DATA

Contact Arrangement		1 A
Max. Switching current		80A
Max. Switching Voltage		14VDC
Contact Rating (resistive)		80A 14VDC
Max. Switching Power		1440W
Contact Material		AgSnO ₂
Initial Contact Resistance		20m Ω
Operational life	Electrical	5 × 10 ⁵ ops
	Mechanical	1 × 10 ⁶ ops

COIL DATA

Standard Type

Nominal Voltage VDC	Pick-up Voltage VDC	Drop-out Voltage VDC	Coil Resistance Ω
6	4.2	0.6	20 ± 10%
12	8.4	1.2	80 ± 10%
24	16.8	2.4	320 ± 10%

CHARACTERISTICS

Initial Insulation Resistance	500M Ω ,500VDC
Dielectric Strength	500VAC
Operate time(at nomi.Volt.)	10ms
Release time(at nomi.Volt.)	10ms
Power Consumption	1.8W
Destructive	98m/s ² (10g)
Shock Resistance	1.3mm, 5to55 Hz
Storage Temperature	-30 $^{\circ}$ C to +105 $^{\circ}$ C
Ambient Temperature	-40 $^{\circ}$ C to +85 $^{\circ}$ C
Unit weight	38.5g
Termination	PCB and Plug-in

Dimensions

mm

Outline Dimensions

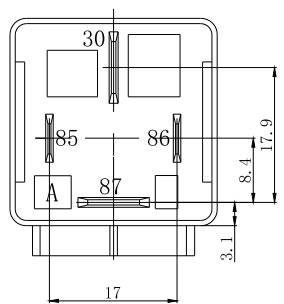
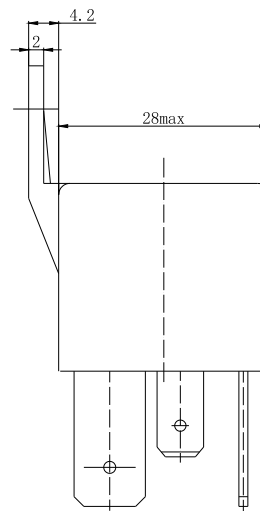
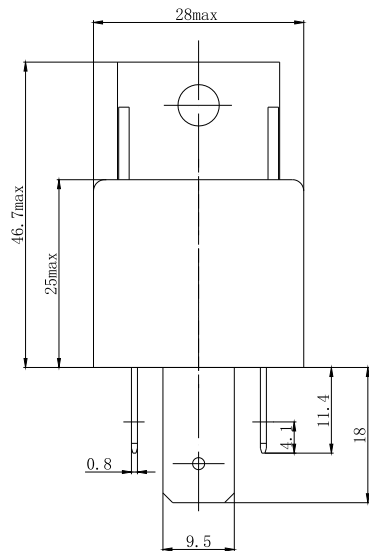

Mounting (Bottom views)

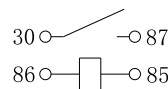

Wiring diagram (Bottom views)