



JRW-211MA Standard T0-5 Hermetically Sealed Relay

● Overview

The relay adopt the technology of hermetically sealed. It has two group of switch contacts (2PDT). The load current can from low level to 1A. Internal diode supply the coil transient suppression protection. It can be used interchangeably with the product of 412D or TS.



● Environment condition

Ambient temperature : $-55\sim 85^{\circ}\text{C}$
Relative humidity : 98% at 40°C
Low air pressure : 4KPa
Shock acceleration : 735m/s^2

Sine vibration : 147m/s^2 , $10\sim 2000\text{Hz}$
Random Vibration : $20(\text{m/s}^2)^2/\text{Hz}$, 169.1m/s^2
Acceleration : 490m/s^2

● Main technical data

Coil power (W): ≤ 0.5	Contact load range : $10\mu\text{A}\sim 1\text{A}$ (Resistive) $10\text{mV}\sim 30\text{Vd.c.}$ $5\sim 115\text{Va.c.}$
Contact resistance : Initial ≤ 100 ($\text{m}\Omega$) After life ≤ 200	
Insulation resistance: normal condition ≥ 10000 ($\text{M}\Omega$) After high electrical level life ≥ 500	Switching power max. : 28 W, 29VA (Resistive)
Dielectric strength (Vr.m.s., 50Hz) : normal condition 500 low air pressure condition 125	Contact load and life : 1A, 28Vd.c., 2×10^4 cycles 0.5A, 28Vd.c., 1×10^5 cycles $10\sim 50\mu\text{A}$, $10\sim 50\text{mV}$, 1×10^5 cycles
Time index: operate time ≤ 2 (ms) Release time ≤ 4	Weight (g) : ≤ 2.6
	Leakage rate : $\leq 10^{-1}\text{Pa}\cdot\text{cm}^3/\text{s}$, and $\leq 10^{-3}\text{Pa}\cdot\text{cm}^3/\text{s}$

● Specification parameter

Order number	Coil Voltage		25 $^{\circ}\text{C}$			-55 $\sim 85^{\circ}\text{C}$	
	Nominal Voltage	Value Max.	Coil Resistance ($1\pm 10\%$) Ω	Pick-up Voltage Max.	Drop-Out Voltage	Pick-up Voltage Max.	Drop-Out Voltage
005	5	6.0	50	3.4	0.4 \sim 1.7	4.1	0.14 \sim 2.5
006	6	7.2	98	4.1	0.5 \sim 2.0	4.9	0.18 \sim 3.0
009	9	10.8	220	6.1	0.8 \sim 3.0	7.4	0.35 \sim 4.5
012	12	14.4	390	8.2	1.0 \sim 4.0	9.8	0.41 \sim 6.0
015	15	18.0	610	10.2	1.1 \sim 5.0	12.3	0.52 \sim 7.5
018	18	21.6	880	12.2	1.2 \sim 6.0	14.7	0.59 \sim 9.0
024	24	28.8	1250	16.3	1.6 \sim 8.0	19.6	0.79 \sim 12.0
027	27	32.4	1560	18.4	2.0 \sim 9.0	22.1	0.90 \sim 13.5

Notes: 1. We can offer many types of coil voltage under the requirement of users.
2. If you have the requirement of leakage rate $\leq 10^{-3}\text{Pa}\cdot\text{cm}^3/\text{s}$, contact us.

● Ordering information

JRW-211MA / 012-2

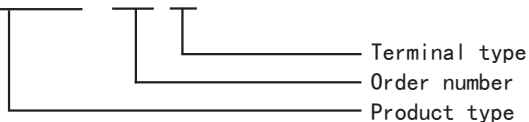



● Load characteristics and coil temperature increase

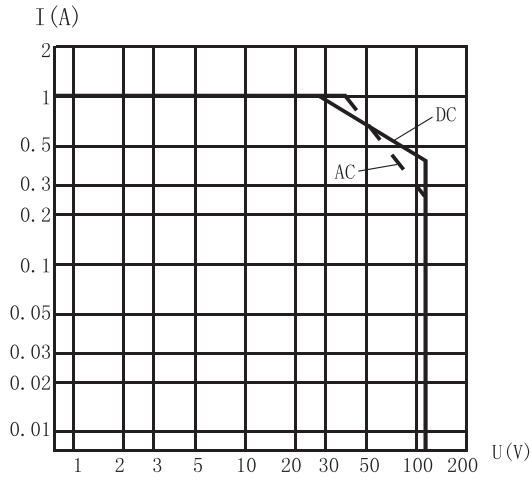

Curve of contact load (Resistive)

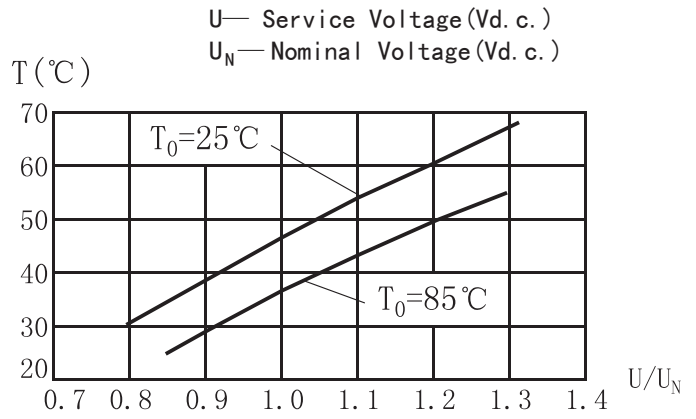

Curve of coil temperature increase
(T_0 —ambient temperature)

● Outline mounting dimensions and bottom view circuit

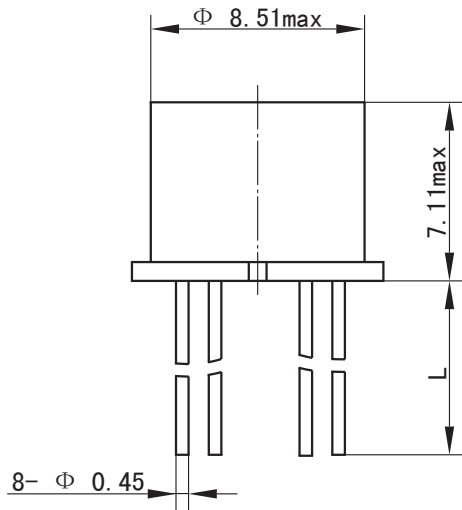

A
A direction

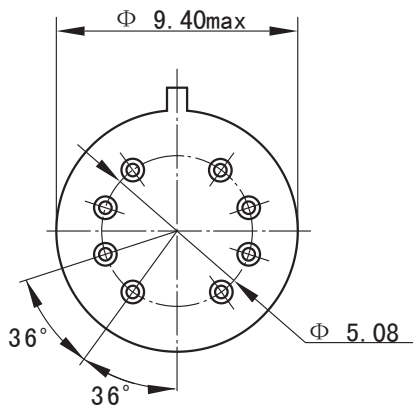

L (mm)	Terminal type
5 ± 0.5	1
12.5min	2

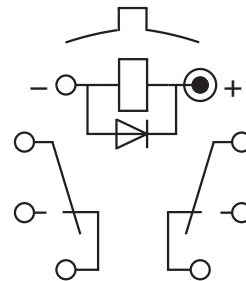

Bottom view circuit